

CERTIFIED RECORD OF LAND CORNER MONUMENTATION

History of original corner establishment:
New corner

DIAGRAM
T10S R31E
E1/16
C-----C
S11

Description of corner evidence found:

Description of monument and accessories I establish to perpetuate the original location of this corner:

Set a 2-1/2"x30" aluminum monument 20" in the ground in a mound of stone.

I establish new bearing trees:

A 9" Juniper bears S49°26'E, 261.1 ft, scribed CE1/16S11BT.

A 1-1/2" aluminum cap on rebar bears S39°17'W, 12.77ft, marked RP CE1/16S11 12.77FT PLS1918.

T10S R31E
E1/16
C-----C
S11
PLS1918
1989

Sun Cadastral Survey
Contract No.: 53-04H1-7-4011
Project No.: 8722K
Field Book: 7-30
Work Accomplished: 4/3/89
Witnesses: Louise Parsons

New BTs have 3/4" brass washers marked PLS1918 attached to the BT blaze, faces and bands painted with red tree marking paint, and BT tags and Attention or Land Survey Monument signs. A steel fence post with Attention or Land Survey Monument sign is driven approximately 3-5 feet from the corner.

PARSONS SURVEYING
1915 S.E. Stone Street
Corvallis, OR 97333
(503) 752-7515

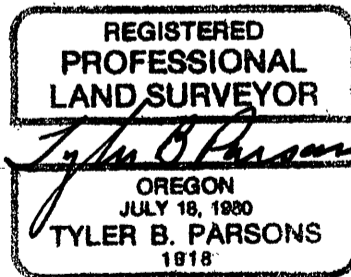

Office of COUNTY SURVEYOR County of GRANT
State of OREGON, I hereby certify that the within instrument was filed in this office
for record on the 26 day of June, 1989

Robert D. Sayre by _____
(COUNTY OFFICIAL) (DEPUTY)